

LEVE CAMBIO
SELECTEURS
GEAR LEVERS

KTM

Art. 7710

KTM EXC 125/250 2t
dal/de/from 2001
(O.R. 547-340-310-00)

IN ALLUMINIO
EN ALUMINIUM
IN ALUMINIUM

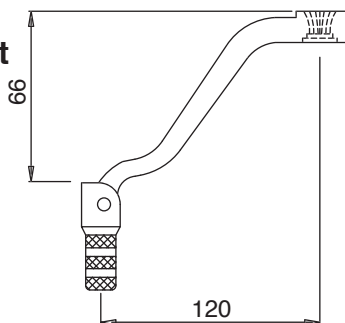

Art. 7712

KTM EXC 250/300 2t
prod. dal/de/from 2005
(O.R. 548-340-31-000)

IN ALLUMINIO
EN ALUMINIUM
IN ALUMINIUM

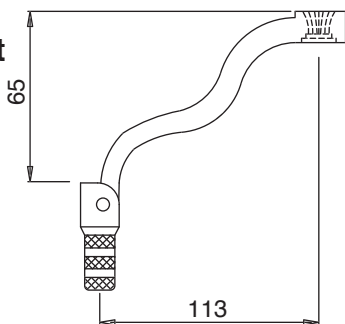

Art. 7714

**KTM EXC Racing,
SMR 400/450/525**
dal/de/from 2000
(O.R. 590-340-31-000)

IN ALLUMINIO
EN ALUMINIUM
IN ALUMINIUM

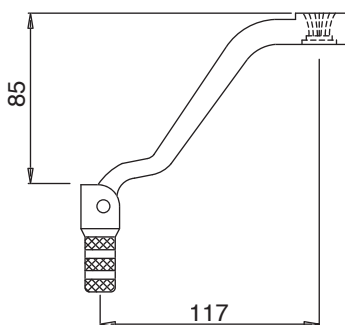

Art. 7716

**KTM LC4 625/640,
SXC 625,
SMC 600/625/990**
dal/de/from '98
(O.R. 584-340-31-044)

IN ALLUMINIO
EN ALUMINIUM
IN ALUMINIUM

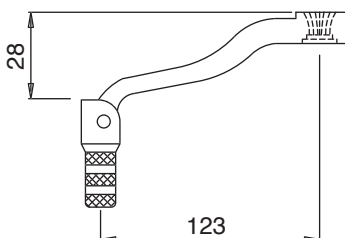

HONDA

Art. 7650

CR - CRF 250 R
prod. dal/de/from 2004
(O.R. 24700-KRN-000)
(O.R. 24700-KZ3-J40)

IN ALLUMINIO
EN ALUMINIUM
IN ALUMINIUM

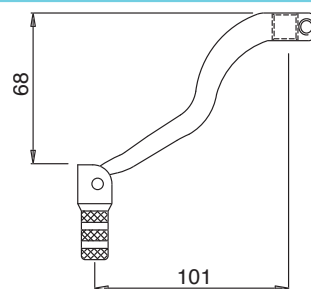

Art. 7652

CRF 450 R
prod. dal/de/from 2004
(O.R. 24700-MEB-771)

IN ALLUMINIO
EN ALUMINIUM
IN ALUMINIUM

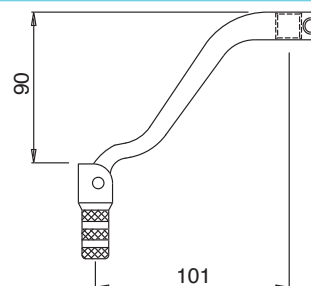

YAMAHA

Art. 7770

YZ - WR 250/450
prod. dal/de/from 2004
(O.R. 5UL-18110-00)

IN ALLUMINIO
EN ALUMINIUM
IN ALUMINIUM

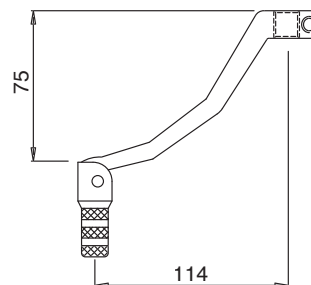

Art. 7781

YAMAHA YZ450F prod.dal/de/from 2007
e altri modelli/et autres modèles/and other models 250 2t

IN ALLUMINIO
EN ALUMINIUM
IN ALUMINIUM

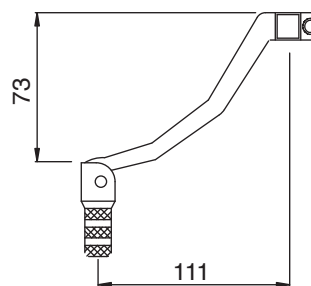

Art. 7250

HONDA 350-600
IN ACCIAIO - EN ACIER - IN STEEL
YAMAHA XT600 Z
TENERE
IN ACCIAIO - EN ACIER - IN STEEL

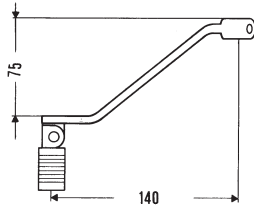

Art. 7595

YAMAHA XT 500-550-600-TENERE
IN ACCIAIO - EN ACIER - IN STEEL

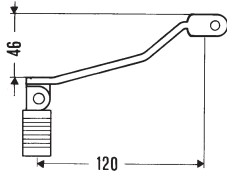

Art. 6760

GENERIC - CPI 50cc 2T - 6 MARCE/VITESSES/GEARS
IN ACCIAIO - EN ACIER - IN STEEL

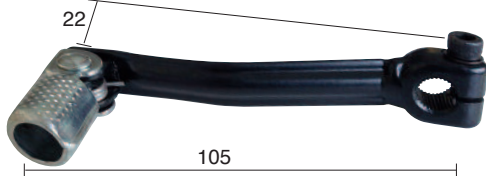

Art. 6780

DERBI 50cc 2T - 6 MARCE
(PERNO CAMBIO CON 20 DENTI)
DERBI 50cc 2T - 6 VITESSES
(ARBRE DU SELECTEUR AVEC 20 DENTS)
DERBI 50cc 2s - 6 GEARS
(GEAR SHAFT WITH 20 TEETH)
VALIDO ANCHE PER / VALABLE AUSSI POUR / VALID ALSO FOR
GILERA 50cc 6 MARCE/VITESSES/GEARS
IN ACCIAIO - EN ACIER - IN STEEL

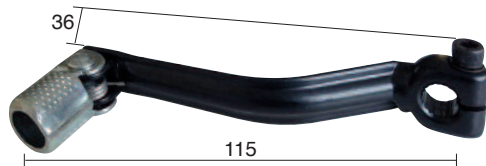

APRILIA - BETA - DERBI - GILERA - MALAGUTI - MBK - YAMAHA - MOTOR HISPANIA - RIEJU

Art. 6806

PER MOTORI MINARELLI 50cc 2t
Con puntale in acciaio zigrinato
POUR MOTEURS MINARELLI 50cc 2t
Avec embout en acier chagriné
FOR MINARELLI 50cc 2s ENGINES
With shagreened steel point
IN ACCIAIO
EN ACIER
IN STEEL

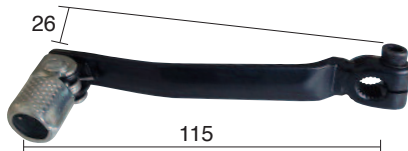

Art. 9525

PROTEZIONE LEVA CAMBIO
PROTECTION SELECTEUR
GEAR LEVER PROTECTION
Conf. / Pack 5 pcs

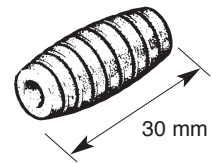

Art. 9526

PROTEZIONE LEVA CAMBIO
PROTECTION SELECTEUR
GEAR LEVER PROTECTION
Conf. / Pack 5 pcs

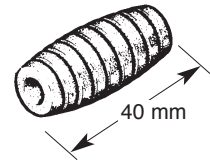

Art. 9527

PROTEZIONE LEVA CAMBIO
PROTECTION SELECTEUR
GEAR LEVER PROTECTION
Conf. / Pack 5 pcs

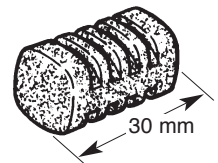

CROSS-ENDURO-SUPERMOTARD

TAPPO SERBATOIO BENZINA

BOUCHON ESSENCE TANK CAP

MOD. CROSS-ENDURO-SUPERMOTARD



COMPLETI DI TUBO PER SFIATO - COLORE NERO
COMPLETE DE EVENT - COULEUR NOIR
COMPLETE WITH VENT - BLACK COLOR

Art. 10200

HONDA CRF

Bocchettone tappo / Goulot bouchon /
Cap filler Ø 64 mm

Art. 10205

KAWASAKI

Bocchettone tappo / Goulot bouchon /
Cap filler Ø 55 mm

Art. 10210

KTM / HUSQ

Bocchettone tappo / Goulot bouchon /
Cap filler Ø 51 mm

Art. 10215

SUZUKI

Bocchettone tappo / Goulot bouchon /
Cap filler Ø 55 mm

Art. 10220

YAMAHA YZ - WR

prod. fino / jusqu'à / till 2002
Bocchettone tappo / Goulot bouchon /
Cap filler Ø 67 mm

Art. 10225

YAMAHA YZ - WR

prod. dal / de / from 2003
Bocchettone tappo / Goulot bouchon /
Cap filler Ø 63 mm